

GROSS LOAD CAPACITY WHEN USED AS A WEIGHT CARRYING HITCH: 2,000 LBS. TRAILER WEIGHT & 200 LBS. TONGUE WEIGHT.

DO NOT EXCEED VEHICLE MANUFACTURER'S RECOMMENDED TOWING CAPACITY.

WARNING: ALL NON-TRAILER LOADS APPLIED TO THIS PRODUCT MUST BE SUPPORTED BY AUXILIARY STABILIZING STRAPS.

** FAILURE TO PROPERLY SUPPORT NON-TRAILER LOADS WILL VOID PRODUCT WARRANTY**

HAVING INSTALLATION QUESTIONS? CALL TECHNICAL SUPPORT AT 1-800-798-0813

Parts List				
ITEM	QTY	PART NUMBER	DESCRIPTION	
1	1	1/2"	FISHWIRE TOOL	
2	4	HFN 1213	HEX FLANGE NUT	
3	2	CM-SP4	.250 x 1.50 x 3.00" SQUARE HOLE SPACER	
4	2	CM-SP10	.250 x 1.00 x 2.50" SQUARE HOLE SPACER	
5	4	1/2-13 x 1 1/2	CARRIAGE BOLT	

RUBBER ISOLATOR REMOVAL DIAGRAM

This technique can be used if and Exhaust Hanger Removal Pliers is not available.

Using a 5/8" open end wrench, slide the wrench up to the rubber isolator, cradling the hanger rod as shown. Next place the flat edge of a pry bar between the wrench and the hanger stop or hanger rod. Then simply rotate the pry bar toward the wrench to remove the rubber isolator.

Note: Using a spray lubricant or soapy water on the hanger rod and the rubber isolator helps removal.

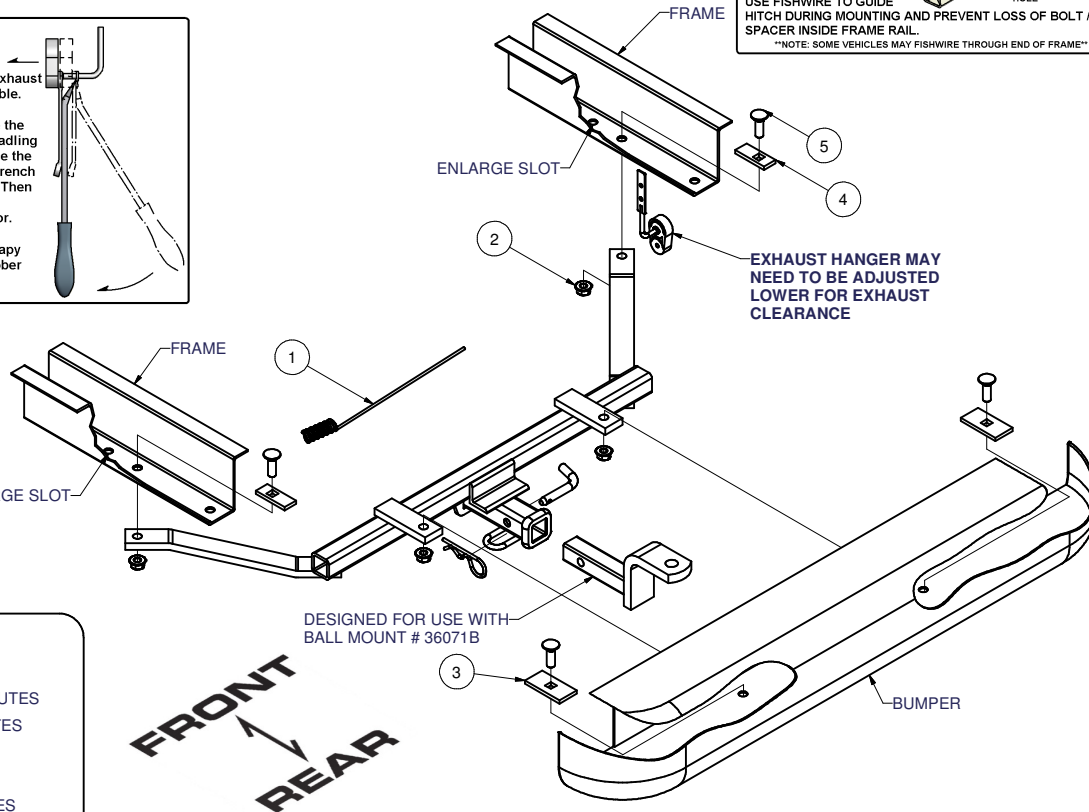

HITCH WEIGHT: 25 LBS.

INSTALL TIME

PROFESSIONAL: 30 MINUTES

NOVICE (DIY): 60 MINUTES

INSTALL NOTES:

- LOWER EXHAUST
- ENLARGE BUMPER HOLES
- ENLARGE FRAME SLOTS

INSTALLATION STEPS

- 1) Lower exhaust by removing rear exhaust hanger.
- 2) Enlarge (2) existing holes in bumper tube to 9/16".
- 3) Enlarge existing slots in frame rails to allow 1/2" carriage bolt to pass through.
- 4) Fishwire carriage bolts and large spacer through ends of bumper tube and out enlarged holes.
- 5) Fishwire carriage bolts and small spacer through enlarged access slot and out existing holes in frame rail.
- 6) Raise hitch into position and secure with flange nuts.
- 7) Torque all 1/2" fasteners to 110 lb-ft
- 8) Reinstall exhaust hanger removed in step 1

PERIODICALLY CHECK THIS RECEIVER HITCH TO ENSURE THAT ALL FASTENERS ARE TIGHT AND THAT ALL STRUCTURAL COMPONENTS ARE SOUND.