

INSTALLATION INSTRUCTIONS

EQUIPMENT REQUIRED:

WIRING ACCESS LOCATION: XX

DRILL BITS: NONE

HITCH REQUIRES 5/8" PIN AND CLIP IF STABILIZING PIN IS NOT INSTALLED.

WRENCHES: (TIGHTEN ALL FASTENERS WITH TORQUE WRENCH) 13mm, 15mm, 18mm, 19mm, 5/8, 11/16

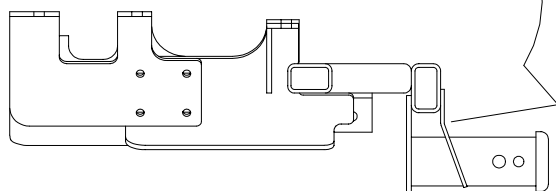

HITCH SHOWN IN PROPER POSITION

VEHICLE
CHRYSLER TOWN & COUNTRY*
DODGE GRAND CARAVAN*

* ONLY FITS VEHICLES WITH STOW 'n GO SEATING

DO NOT EXCEED LOWER OF
TOWING VEHICLE MFR'S RATINGS OR

HITCH TYPE ▼	MAX GROSS TRLR WT(LB)	MAX TONGUE WT(LB)
WEIGHT DISTRIBUTING	5000	500
WEIGHT CARRYING BALL MOUNT	3500	350

WARNING: REMOVING ALL FASTENERS AT ONCE
WILL CAUSE BUMPER BRACKETS TO
SLIP OUT OF POSITION.
PLEASE FOLLOW STEP-BY-STEP
INSTRUCTIONS TO PREVENT THIS.

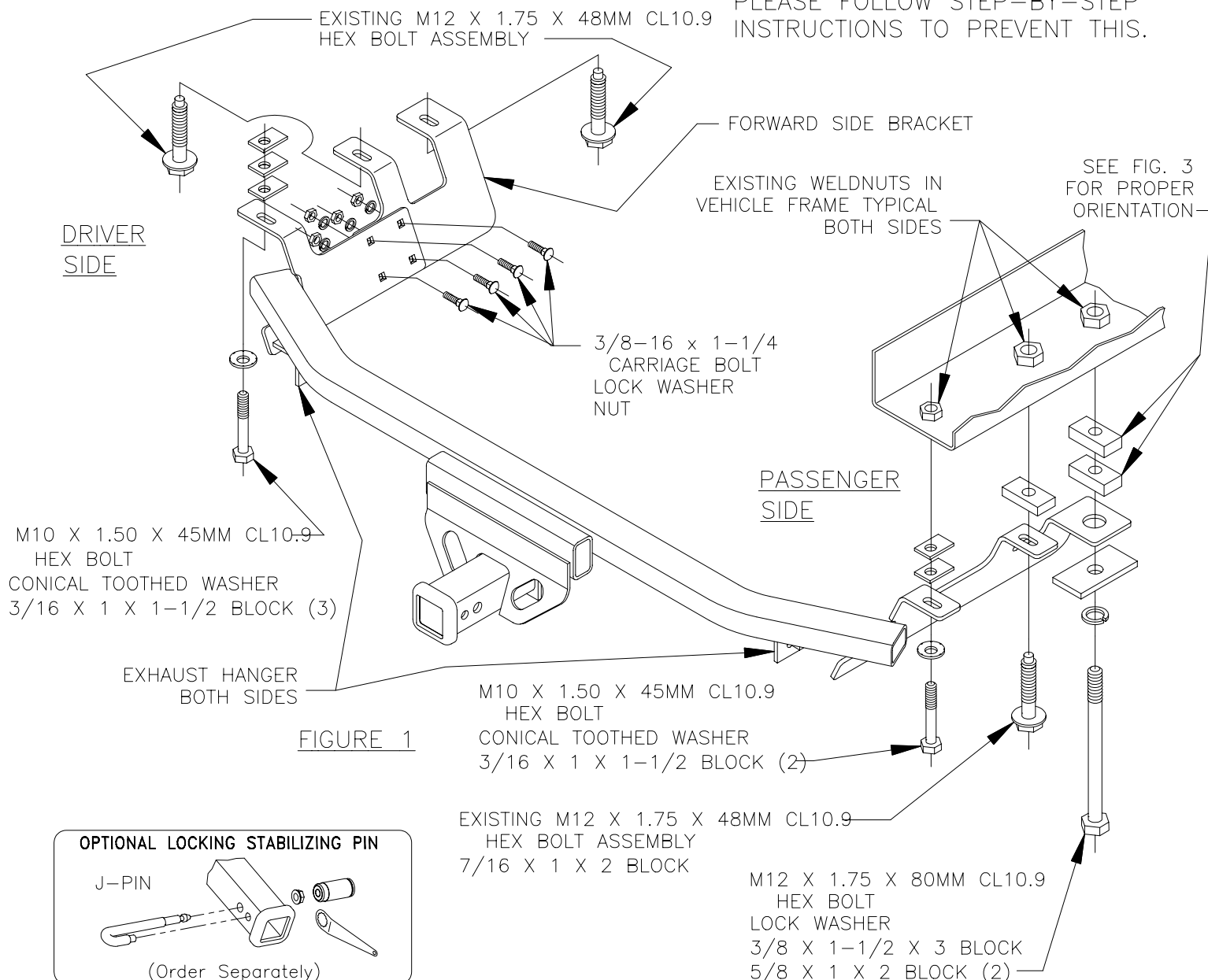
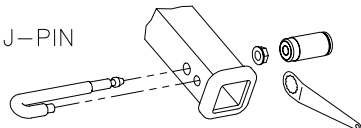

FIGURE 1

OPTIONAL LOCKING STABILIZING PIN

J-PIN



(Order Separately)

THIS PRODUCT COMPLIES WITH SAFETY SPECIFICATIONS AND REQUIREMENTS FOR CONNECTING DEVICES AND TOWING SYSTEMS OF THE STATE OF NEW YORK, V.E.S.C. REGULATION V-5 AND SAE J684.

APPROX WEIGHT (LB.)

54

FASTENER KIT

F75166

NOTE: Check hitch frequently, making sure all fasteners and ball are properly tightened. If hitch is removed, plug all holes in trunk pan or other body panels to prevent entry of water and exhaust fumes. A hitch or ball which has been damaged should be removed and replaced. Observe safety precautions when working beneath vehicle and wear eye protection. Follow car maker's specs for maximum trailer weight and tongue weight. Do not cut access or attachment holes with a torch.

TOWING PRODUCTS
Plymouth, Michigan

INSTALLATION INSTRUCTIONS

VEHICLE

CHRYSLER TOWN & COUNTRY*
DODGE GRAND CARAVAN*

* ONLY FITS VEHICLES WITH STOW 'n GO SEATING

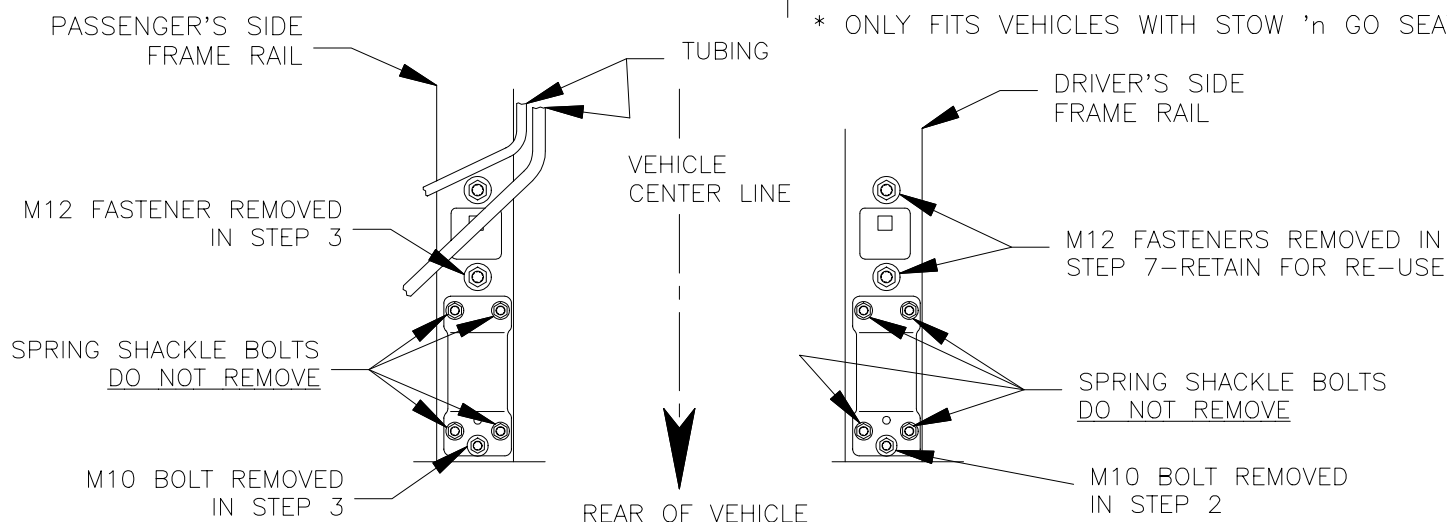

FIGURE 2

VIEWED FROM UNDER VEHICLE

WARNING: REMOVING ALL FASTENERS AT ONCE WILL CAUSE BUMPER BRACKETS TO SLIP OUT OF POSITION. FOLLOW STEP-BY-STEP INSTRUCTIONS TO PREVENT THIS.

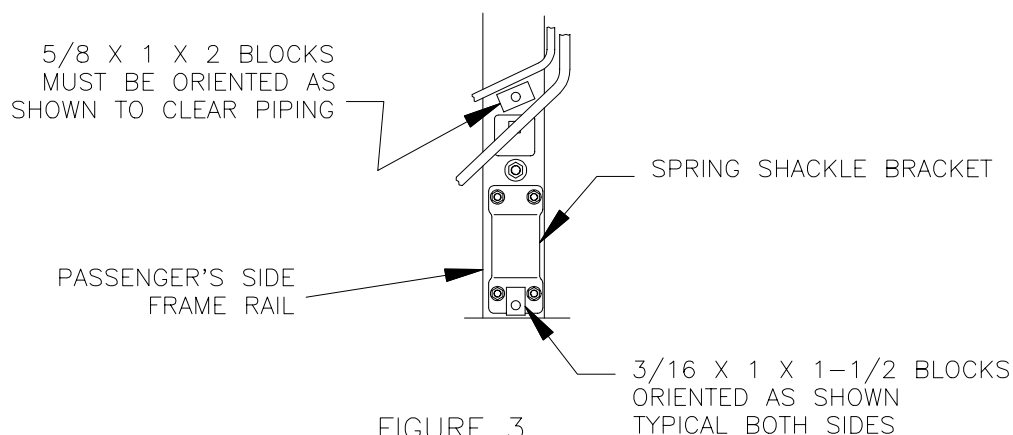

FIGURE 3

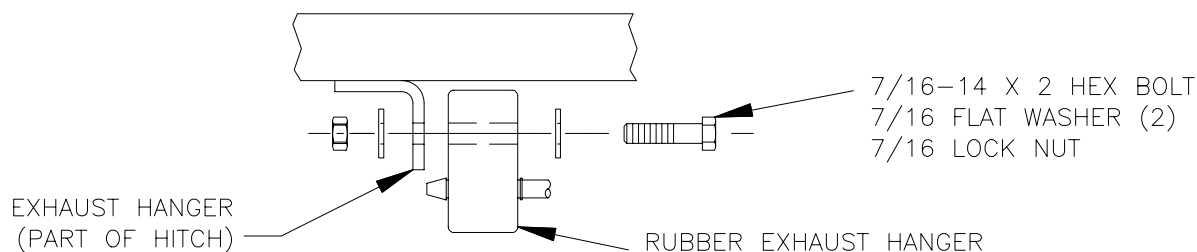

FIGURE 4

RE-ATTACHMENT OF EXHAUST HANGERS

THIS PRODUCT COMPLIES WITH SAFETY SPECIFICATIONS AND REQUIREMENTS FOR CONNECTING DEVICES AND TOWING SYSTEMS OF THE STATE OF NEW YORK, V.E.S.C. REGULATION V-5 AND SAE J684.

APPROX WEIGHT (LB.)

54

FASTENER KIT

F75166

NOTE: Check hitch frequently, making sure all fasteners and ball are properly tightened. If hitch is removed, plug all holes in trunk pan or other body panels to prevent entry of water and exhaust fumes. A hitch or ball which has been damaged should be removed and replaced. Observe safety precautions when working beneath a vehicle and wear eye protection. Follow car maker's specs for maximum trailer weight and tongue weight. Do not cut access or attachment holes with a torch.

TOWING PRODUCTS
Plymouth, Michigan

INSTALLATION INSTRUCTIONS

VEHICLE

CHRYSLER TOWN & COUNTRY*
DODGE GRAND CARAVAN*

* ONLY FITS VEHICLES WITH STOW 'n GO SEATING

WARNING: REMOVING ALL FASTENERS AT ONCE WILL CAUSE BUMPER BRACKETS TO SLIP OUT OF POSITION. FOLLOW STEP-BY-STEP INSTRUCTIONS TO PREVENT THIS.

1. LOWER EXHAUST BY UNBOLTING (3) EXHAUST HANGER BRACKETS; (2) AT VEHICLE CROSSMEMBER AND (1) FORWARD OF REAR AXLE. REMOVE (2) REARMOST STEEL EXHAUST HANGER BRACKETS FROM RUBBER EXHAUST HANGERS AND RETURN TO VEHICLE OWNER.
2. ON DRIVER'S SIDE, REMOVE REARMOST M10 FASTENER AS SHOWN IN FIGURE 2 AND RETURN TO VEHICLE OWNER.
3. ON PASSENGER'S SIDE, REMOVE REARMOST M10 AND M12 FASTENERS AS SHOWN IN FIGURE 2 AND RETURN TO VEHICLE OWNER.
4. INSTALL (4) 3/8" CARRIAGE BOLTS DOWN THRU SQUARE HOLES IN DRIVER'S SIDE BRACKET.

SUGGESTION: INSTALL 3/8" NUTS FINGER-TIGHT ONTO CARRIAGE BOLTS TO PREVENT BOLTS FROM FALLING OUT DURING INSTALLATION.

NOTE: DO NOT ATTACH FORWARD SIDE BRACKET AT THIS TIME. THIS WILL BE DONE IN STEP 7.

5. RAISE HITCH INTO POSITION. INSTALL BLOCKS AND BOLTS PROVIDED WITH HITCH AS SHOWN IN FIGURE 1. THESE BOLTS REPLACE VEHICLE BOLTS REMOVED IN STEP 2 & 3.
6. ON PASSENGER'S SIDE, REMOVE FORWARDMOST M12 FASTENER THRU LARGE HOLE IN HITCH BRACKET AND RETURN TO VEHICLE OWNER. INSTALL NEW BLOCKS AND BOLTS AS SHOWN IN FIGURES 1 & 3.

NOTE: (2) 5/8" THICK BLOCKS MUST BE ORIENTED AS SHOWN IN FIGURE 3 TO ENSURE THAT BLOCKS DO NOT PINCH TUBING WHEN TIGHTENING BOLT.

7. ON DRIVER'S SIDE, REMOVE (2) M12 FASTENERS AS SHOWN IN FIGURE 2 AND RETAIN FOR RE-USE. REMOVE 3/8" NUTS FROM CARRIAGE BOLTS (INSTALLED IN STEP 4) AND INSTALL FORWARD SIDE BRACKET AS SHOWN. REINSTALL M12 BOLTS. INSTALL 3/8" LOCKWASHERS AND NUTS.

TIGHTEN M10 CL10.9 FASTENERS TO 53 LB.-FT.

TIGHTEN M12 CL10.9 FASTENERS TO 92 LB.-FT.

TIGHTEN 3/8 GR5 FASTENERS TO 31 LB.-FT.

8. REATTACH EXHAUST HANGER BRACKET FORWARD OF REAR AXLE.
9. ATTACH REARWARD EXHAUST HANGERS TO HITCH AS SHOWN IN FIGURE 4.

THIS PRODUCT COMPLIES WITH SAFETY SPECIFICATIONS AND REQUIREMENTS FOR CONNECTING DEVICES AND TOWING SYSTEMS OF THE STATE OF NEW YORK, V.E.S.C. REGULATION V-5 AND SAE J684.

APPROX WEIGHT (LB.)

54

FASTENER KIT

F75166

NOTE: Check hitch frequently, making sure all fasteners and ball are properly tightened. If hitch is removed, plug all holes in trunk pan or other body panels to prevent entry of water and exhaust fumes. A hitch or ball which has been damaged should be removed and replaced. Observe safety precautions when working beneath a vehicle and wear eye protection. Follow car maker's specs for maximum trailer weight and tongue weight. Do not cut access or attachment holes with a torch.

TOWING PRODUCTS
Plymouth, Michigan