

GROSS LOAD CAPACITY WHEN USED AS A WEIGHT CARRYING HITCH: 3,500 LBS. TRAILER WEIGHT & 350 LBS. TONGUE WEIGHT.
DO NOT EXCEED VEHICLE MANUFACTURER'S RECOMMENDED TOWING CAPACITY.

Parts List			
ITEM	QTY	PART NUMBER	DESCRIPTION
1	1	CM-12058-BK	HITCH BOLT KIT
1.1	1	1/2"	FISHWIRE TOOL
1.2	4	1/2 - 13	HEX FLANGE NUT
1.3	4	1/2 - 13 x 1 3/4	CARRIAGE BOLT
1.4	2	M8-1.25 x 35	HEX BOLT
1.5	2	3/8"	CONICAL TOOTHED WASHER
2	4	CM-SP6	1.00 x 3.00 x .250 INSTALLATION SPACER

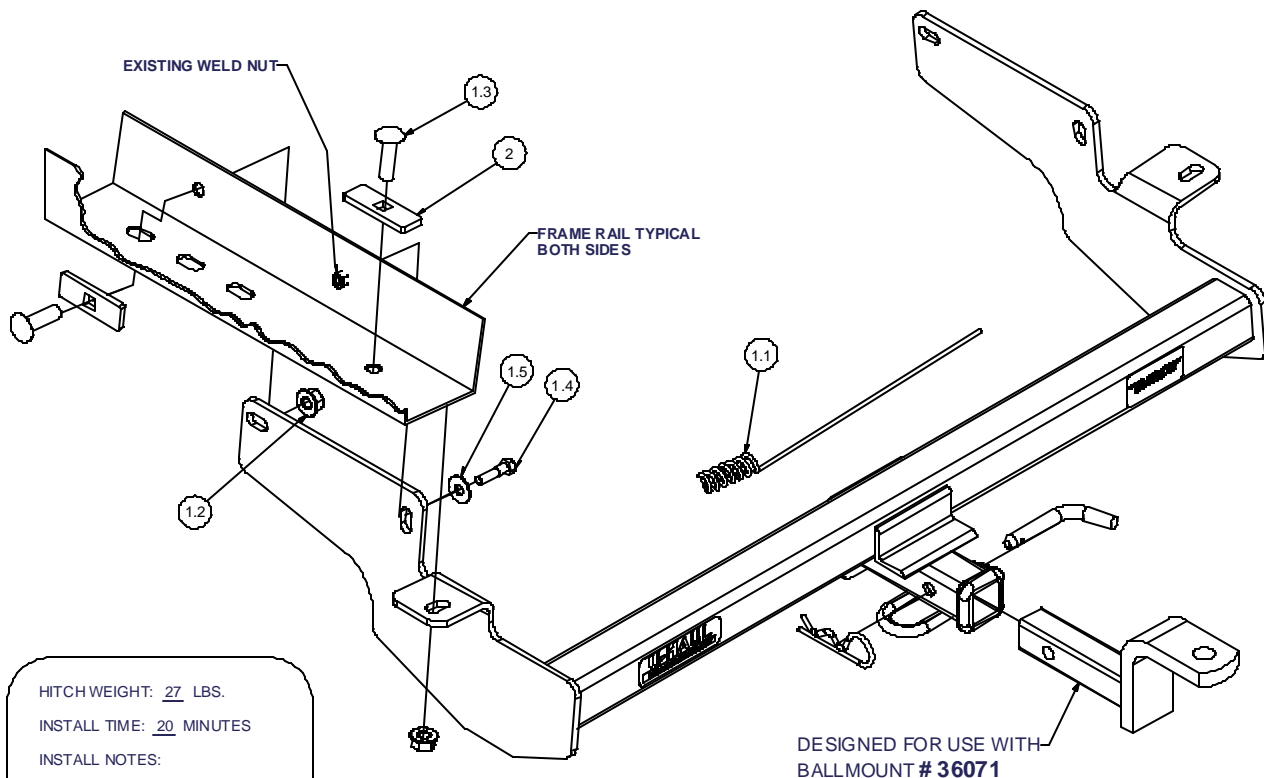

HITCH WEIGHT: 27 LBS.
INSTALL TIME: 20 MINUTES
INSTALL NOTES:

INSTALLATION STEPS

- 1) Raise hitch into position.
- 2) Install two M8 bolts into existing weldnuts as shown.
- 3) Fishwire remaining fasteners as shown. Note: 1/2" bolt and block must be inserted separately into access hole during fishwiring process.
- 4) Torque M8 fasteners to 25 lb.-ft. Torque all 1/2" fasteners to 75 lb.-ft.

PERIODICALLY CHECK THIS RECEIVER HITCH TO INSURE THAT ALL FASTNERS ARE TIGHT AND THAT ALL STRUCTURAL COMPONENTS ARE SOUND.

Curt Manufacturing Inc., warrants this product to be free of defects in material and/or workmanship at the time of retail purchase by the original purchaser. If the product is found to be defective, Curt Manufacturing Inc., may repair or replace the product, at their option, when the product is returned, prepaid, with proof of purchase. Alteration to, misuse of, or improper installation of this product voids the warranty. Curt Manufacturing Inc.'s liability is limited to repair or replacement of products found to be defective, and specifically excludes liability for incidental or consequential loss or damage.