

GROSS LOAD CAPACITY WHEN USED AS A WEIGHT CARRYING HITCH: 3,500 LBS. TRAILER WEIGHT & 350 LBS. TONGUE WEIGHT.
DO NOT EXCEED VEHICLE MANUFACTURER'S RECOMMENDED TOWING CAPACITY.

Parts List			
ITEM	QTY	PART NUMBER	DESCRIPTION
1	1	CM-12040-BK	HITCH BOLT KIT
1.1	1	1/2"	FISHWIRE TOOL
1.2	4	1/2 - 13 x 2"	CARRIAGE BOLT
1.3	4	1/2 - 13	HEX FLANGE NUT
2	2	CM-SP31	1.75 X 2.00 X .25 INSTALLTION SPACER
3	4	CM-SP19	1.25 x 3.00 x .25 INSTALLATION SPACER

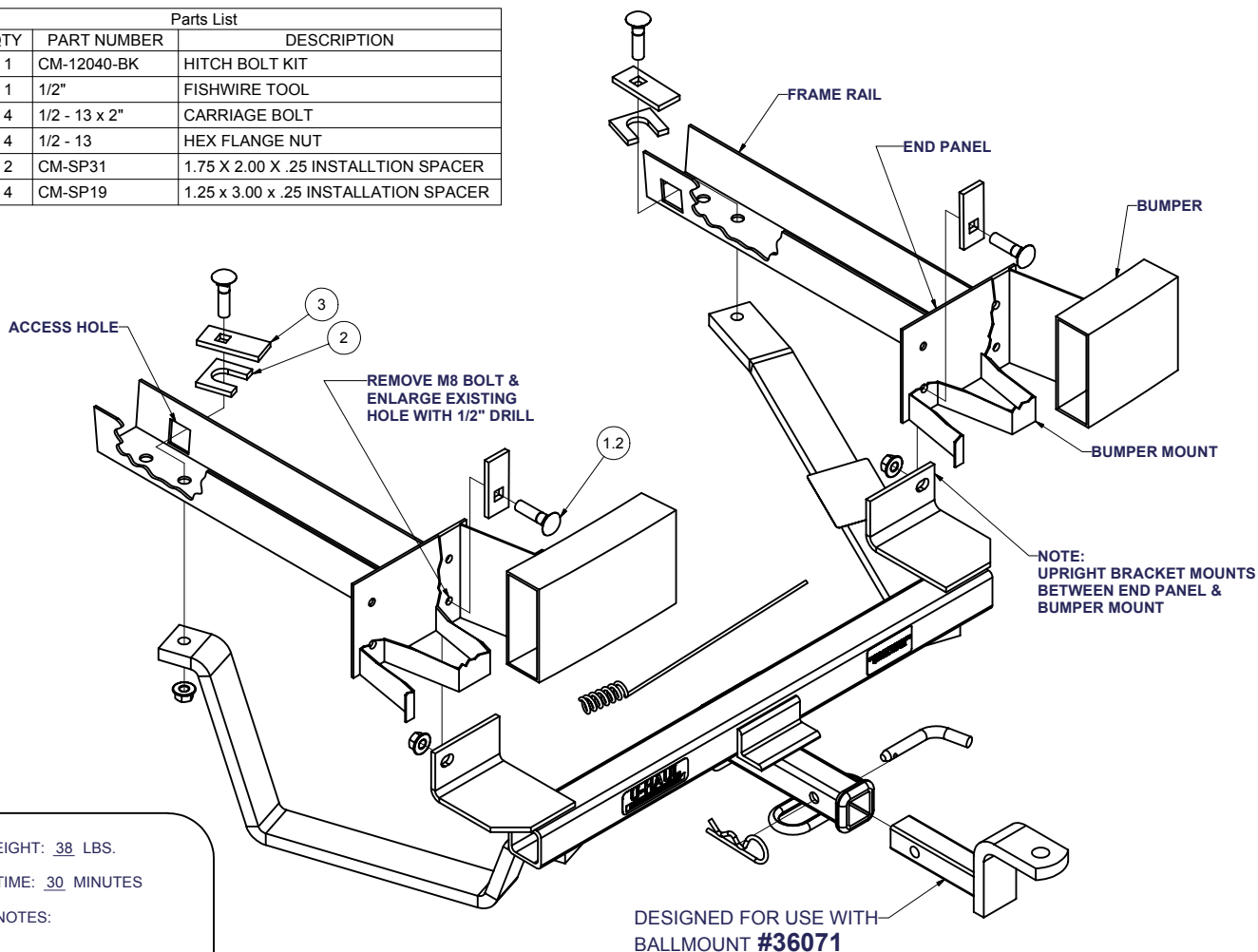

HITCH WEIGHT: 38 LBS.

INSTALL TIME: 30 MINUTES

INSTALL NOTES:

INSTALLATION STEPS

- 1) Remove existing M8 bumper bolts located on the inboard side of frame end panel (both sides).
Hint: Break off plastic tab and unscrew bolt from frame.
- 2) Enlarge existing holes with a 1/2" drill bit.
- 3) Raise hitch into position, aligning hitch with holes in vehicle end panel and holes in bottom of frame rail.
- 4) Install carriage bolt and block thru holes in end panel and hitch upright bracket.
- 5) Fishwire the 1/2" carriage bolt and blocks inside frame rail thru access hole. The "C" shaped block goes in first, next to the frame as shown.
- 6) **NOTE: Be sure to keep "C" shaped block centered around hole inside frame rail.**
- 7) Torque all 1/2 handle nut to 50 LB.-FT. Torque all 1/2 fasteners to 75 LB-FT

**PERIODICALLY CHECK THIS RECEIVER HITCH TO INSURE THAT ALL FASTNERS
ARE TIGHT AND THAT ALL STRUCTURAL COMPONENTS ARE SOUND.**